

**SURULIA MINI ZOO, REVISED MASTER LAYOUT PLAN  
MAP-2, PROPOSED LAYOUT PLAN WITH CONTOUR**

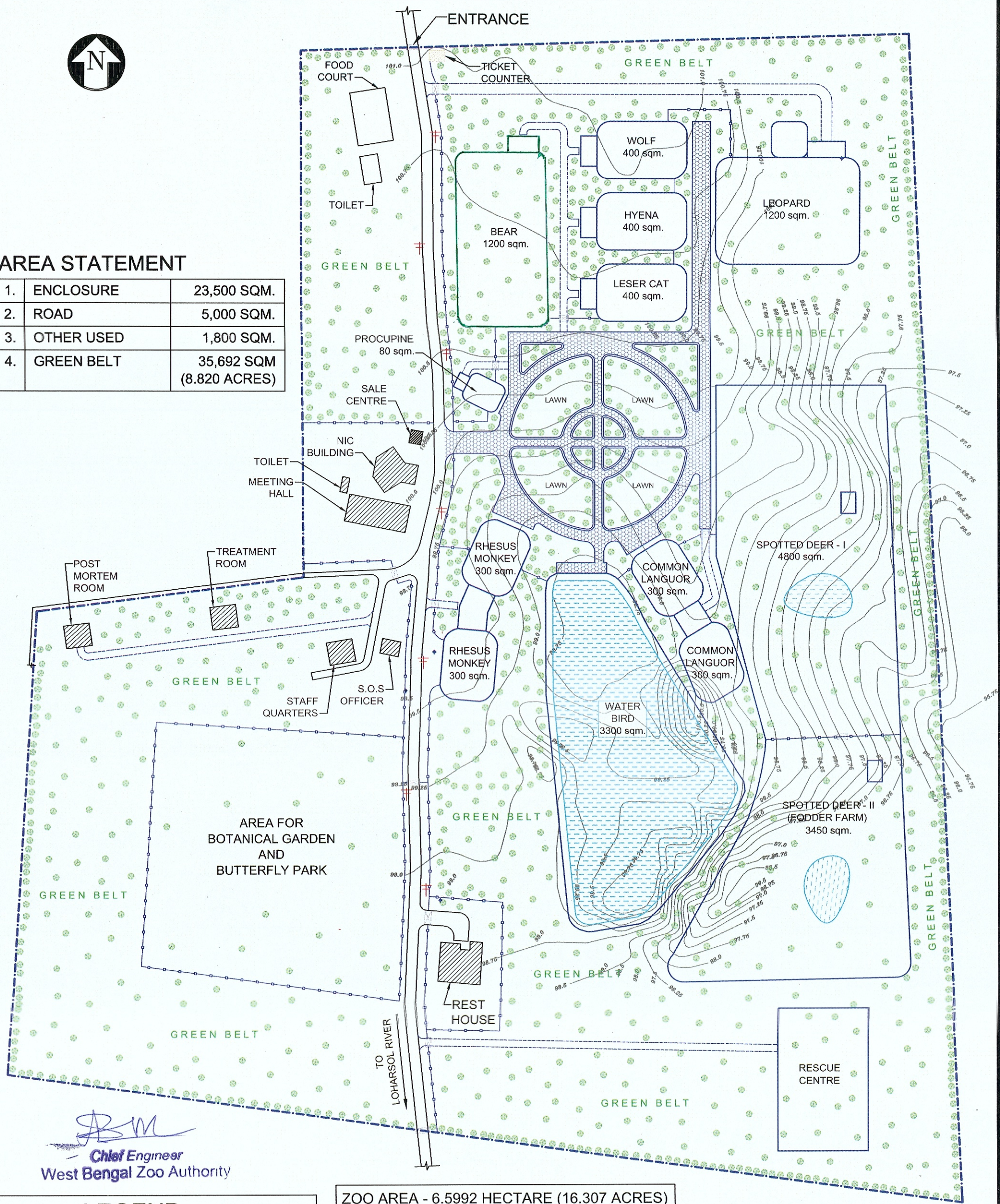

**AREA STATEMENT**

1.	ENCLOSURE	23,500 SQM.
2.	ROAD	5,000 SQM.
3.	OTHER USED	1,800 SQM.
4.	GREEN BELT	35,692 SQM (8.820 ACRES)



*BM*  
**Chief Engineer**  
West Bengal Zoo Authority

ZOO AREA - 6.5992 HECTARE (16.307 ACRES)

LEGEND		
1.	ZOO BOUNDARY	---
2.	VISITORS ROAD	====
3.	SERVICE ROAD	----
4.	SERVICE GATE	⊠
5.	FENCING	—○—○—○—
6.	WATER BODY	▒▒▒▒

*Kyadav*  
**Member Secretary**  
West Bengal Zoo Authority

*Alan*  
**Sub - Assistant Engineer**  
West Bengal Zoo Authority

OWNER:		WEST BENGAL ZOO AUTHORITY KB-19, 2ND. FLOOR, SECTOR-III, SALT LAKE CITY, KOLKATA-700 098		
PROJECT:		SURULIA MINI ZOO SURULIA, DIST.- PURULIA, WEST BENGAL		
TITLE:		MASTER LAYOUT PLAN		SCALE: 1:1000
				DATE: 03.01.17
APPROVE BY	DRAWN BY	DRG. NO.	SHEET	REV
	A. KHAN	WBZA/DE/D10/MLP-CON	1 OF 1	1

SHEET - A3

The Master (Layout) Plan of the Surulia Mini Zoo, District Purulia, West Bengal was approved by the Central Zoo Authority in its 30<sup>th</sup> Meeting held on 28<sup>th</sup> September, 2017 vide agenda item No. 7 based on recommendation of the Technical Committee of the CZA in its 84<sup>th</sup> meeting held on 19<sup>th</sup> September, 2017 vide agenda No.4(6) and on receipt of compliance submitted vide letter No.432/WBZA/T-12/17-18 dated 06.09.2017.

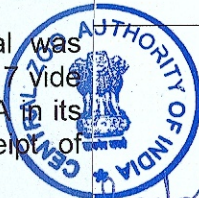

*Dr. D. N. Singh*  
**Dr. D. N. SINGH, IFS**  
Member Secretary  
Central Zoo Authority  
Ministry of Environment, Forest & Climate Change  
Govt. of India, New Delhi-110003

11.07.2017